

NOTICE OF PROPOSED RENEWAL AND GRANT OF MINING CLAIMS

NATIVE TITLE ACT 1993 (CTH) SECTION 29

The Queensland Minister for Resources and Critical Minerals, PO Box 15216, City East, Queensland, 4002, hereby gives notice in accordance with section 29 of the *Native Title Act 1993* (Cth) of the proposed renewal and grant of Mining Claim (MC) shown below, subject to provisions of the *Mineral Resources Act 1989* (Qld).

MC 70770 renewal applied for by John Richard Akers, over an area of 884m², centred approximately 7.24 km west of Sapphire, in the locality of the Central Highlands Regional Council.

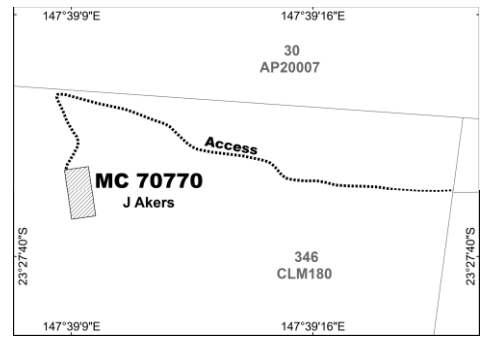

MC 70884 renewal applied for by Wendy Joy Gorman, over an area of 900m², centred approximately 540m east south-east of Sapphire, in the locality of the Central Highlands Regional Council.

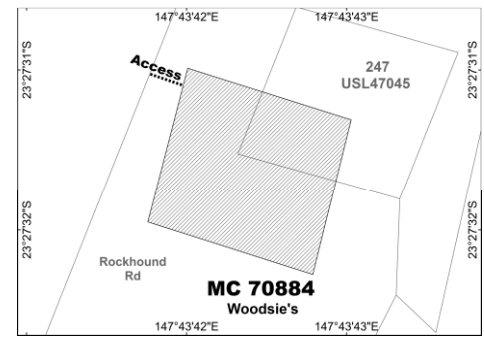

MC 300451 applied for by Katelyn Annette Wagner, over an area of 894m², centred approximately 1.33 km north east of Sapphire, in the locality of the Central Highlands Regional Council.

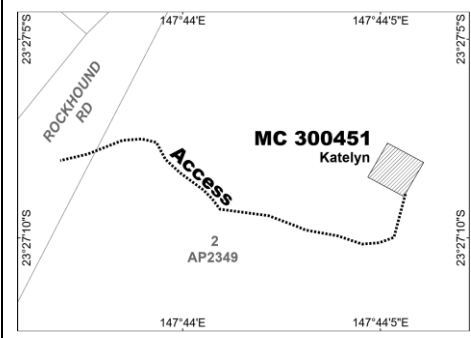

MC 300454 applied for by Brian Joseph Staib, over an area of 900m², centred approximately 1.35 km north east of Sapphire, in the locality of the Central Highlands Regional Council.

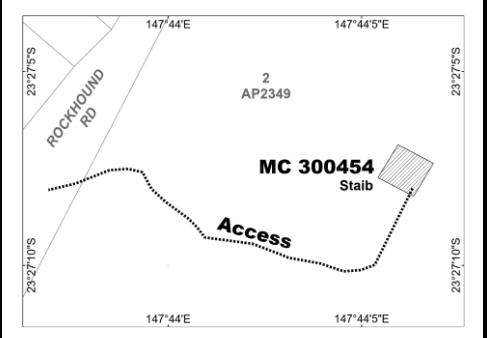

MC 300460 applied for by Nadine Barlow, over an area of 0.4080 ha, centred approximately 3.6 km south east of Rubyvale, in the locality of the Central Highlands Regional Council.

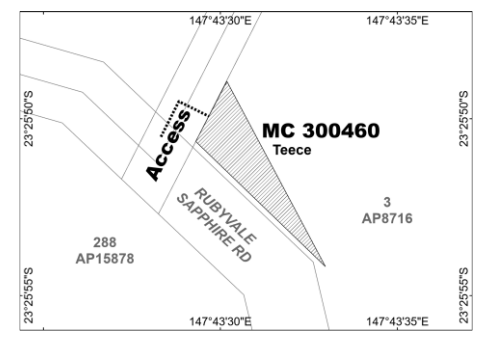

MC 300476 applied for by Timothy Daniel Kemp, over an area of 816m², centred approximately 3.57 km west of Rubyvale, in the locality of the Central Highlands Regional Council.

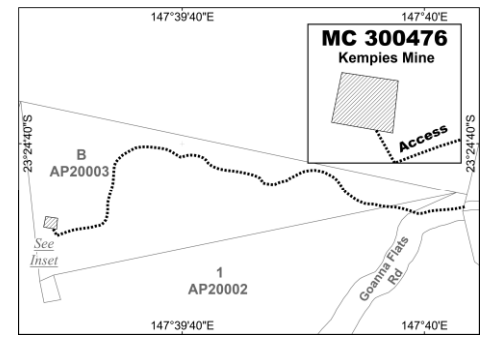

MC 300477 applied for by Angelica Camalla Leary, over an area of 900m², centred approximately 3.91 km west of Rubyvale, in the locality of the Central Highlands Regional Council.

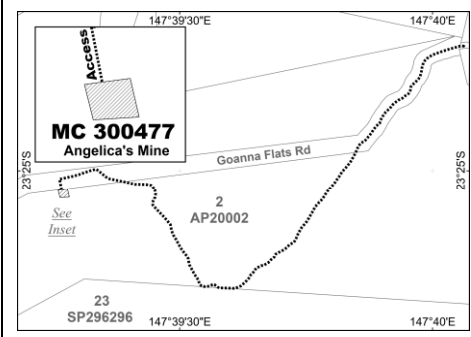

MC 300478 applied for by Elizabeth Louise Evans, over an area of 893m², centred approximately 4 km west of Rubyvale, in the locality of the Central Highlands Regional Council.

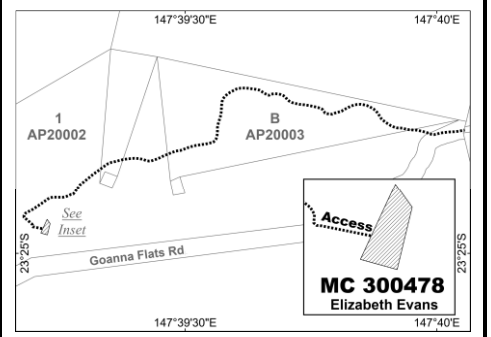

MC 300479 applied for by Steven Evans, over an area of 877m², centred approximately 4 km west of Rubyvale, in the locality of the Central Highlands Regional Council.

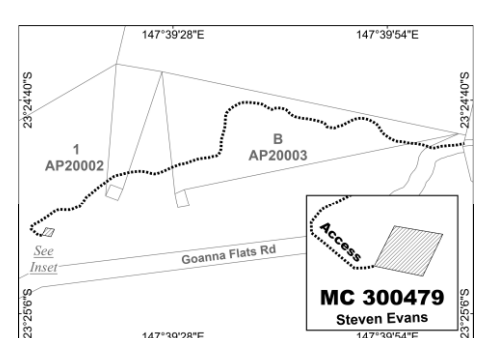

MC 300483 applied for by Bernard William Cannon, over an area of 900m², centred approximately 4.01 km west of Rubyvale, in the locality of the Central Highlands Regional Council.

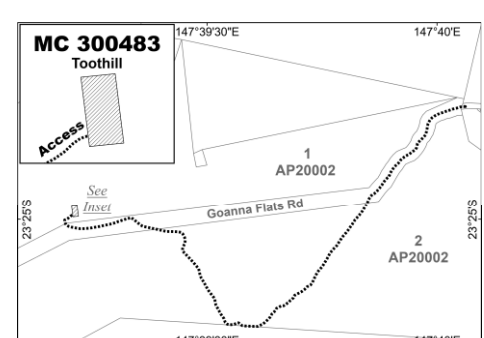

MC 300484 applied for by Maurice Robert Fox, over an area of 900m², centred approximately 4.02 km west of Rubyvale, in the locality of the Central Highlands Regional Council.

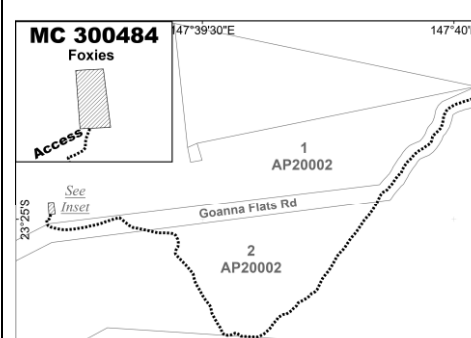

MC 300485 applied for by John Charles Bell, over an area of 817m², centred approximately 862m north west of Rubyvale, in the locality of the Central Highlands Regional Council.

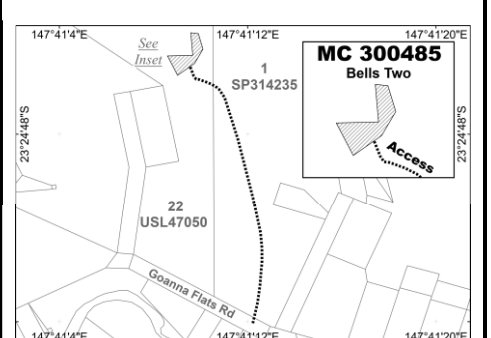

MC 300486 applied for by Anthony Morgan Warwick, over an area of 900m², centred approximately 3.58 km west of Rubyvale, in the locality of the Central Highlands Regional Council.

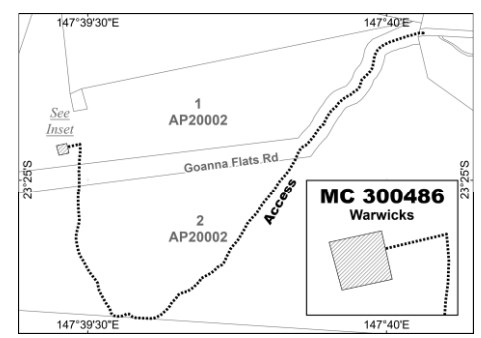

MC 300489 applied for by Daniel James Chafer, over an area of 664m², centred approximately 7.15 km south west of Rubyvale, in the locality of the Central Highlands Regional Council.

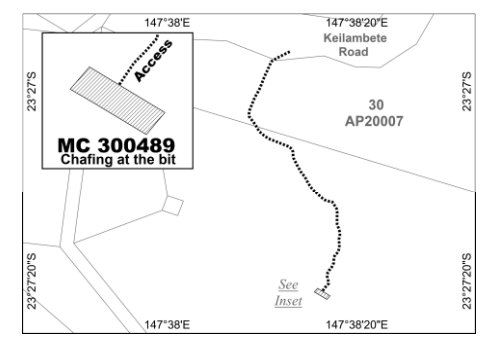

MC 300492 applied for by Annette Margaret Ungerer, over an area of 900m², centred approximately 3.26 km west of Rubyvale, in the locality of the Central Highlands Regional Council.

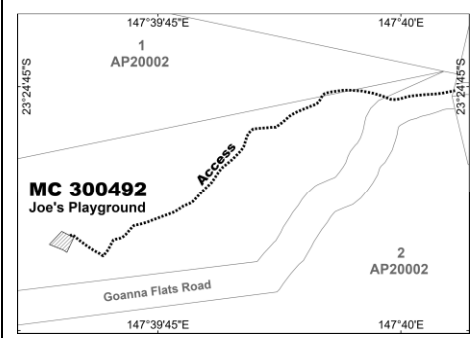

MC 300493 applied for by Wayne Norman Gardiner, over an area of 900m², centred approximately 822m north north-west of Rubyvale, in the locality of the Central Highlands Regional Council.

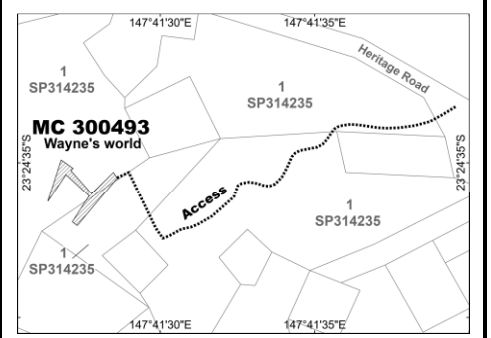

MC 300494 applied for by Gail Dark, over an area of 870m², centred approximately 1.43 km north west of Rubyvale, in the locality of the Central Highlands Regional Council.

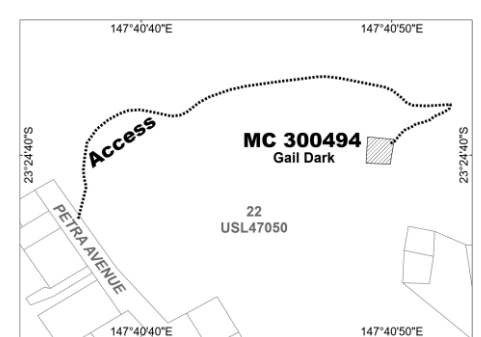

MC 300496 applied for by Shayne Donald Heron, over an area of 900m², centred approximately 1.49 km north west of Rubyvale, in the locality of the Central Highlands Regional Council.

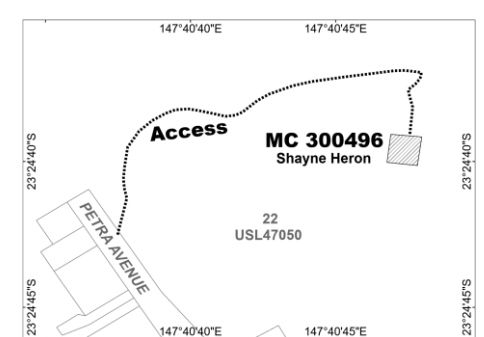

MC 300497 applied for by Bradley James Heron, over an area of 900m², centred approximately 1.45 km north west of Rubyvale, in the locality of the Central Highlands Regional Council.

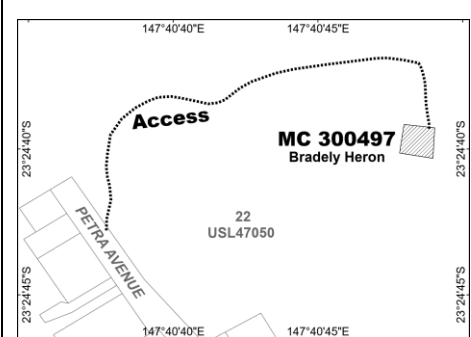

MC 300500 applied for by Sarah Jane Blewitt, over an area of 822m², centred approximately 1.48 km north west of Rubyvale, in the locality of the Central Highlands Regional Council.

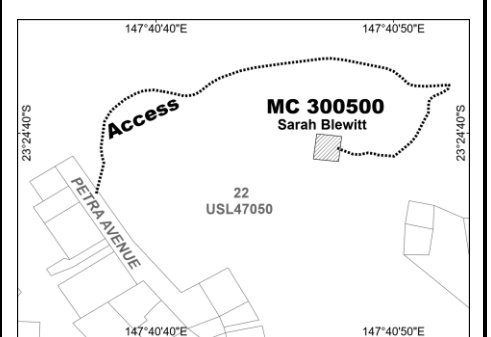

Nature of Act(s): The renewal and grant of Mining Claims under the *Mineral Resources Act 1989* (Qld) authorises the holder to mine and carry out associated activities subject to the *Mineral Resources Act 1989* (Qld) for a term not exceeding ten (10) years, with the possibility of renewals for terms not exceeding ten (10) years. The grant of the Mining Claim includes granting of access as shown above.

Name and Address of person doing Act(s): It is proposed that the Mining Claims be renewed and granted subject to the provisions of the *Mineral Resources Act 1989* (Qld) by the Queensland Minister for Resources and Critical Minerals, PO Box 15216, City East, Queensland, 4002.

Native Title Parties: Under the *Native Title Act 1993* (Cth) any person who is a "native title party" is entitled to certain rights in relation to the proposed renewal and grant of a Mining Claim. Under section 30 of the *Native Title Act 1993* (Cth), persons have until three (3) months after the Notification Day to take certain steps to become native title parties in relation to this notice. Enquiries in relation to filing a native title determination application may be directed to the Federal Court, Brisbane Registry, Level 6, Harry Gibbs Commonwealth Law Courts Building, 119 North Quay, Brisbane, Queensland, 4000. Telephone: 1300 720 980 or Email: nativetitleQLD@fedcourt.gov.au. Enquiries in relation to the registration of a native title determination application may be directed to the National Native Title Tribunal, Brisbane Registry, Level 5, Harry Gibbs Commonwealth Law Courts Building, 119 North Quay, Brisbane, Queensland, 4000. Telephone: (07) 3052 4040.

Further Information: May be obtained from the Department of Resources, Small Scale Mining Assessment Hub, 99 Hospital Road, Emerald, Queensland, 4720. Telephone: (07) 3078 3031 or Email: SSMHub@resources.qld.gov.au.

Notification Day: 23 OCTOBER 2024.

Dated: 13 SEPTEMBER 2024

Signed:

Executive Director,
for Minister for Resources and Critical Minerals.

