

NOTICE OF PROPOSED GRANT OF EXPLORATION PERMIT FOR MINERALS AND MINING CLAIM

NATIVE TITLE ACT 1993 (CTH) SECTION 29

The Queensland Minister for Resources and Critical Minerals, PO Box 15216, City East, Queensland, 4002, hereby gives notice in accordance with section 29 of the Native Title Act 1993 (Cth) of the proposed grant of Exploration Permit for Minerals (EPM) and Mining Claim (MC) shown below, subject to provisions of the *Mineral Resources Act 1989* (Qld).

EPM 28932 applied for by AUSTRALIAN INDIGENOUS SECURITY SERVICE PTY LTD, ACN 122 200 622, over an area of 4 sub-blocks (12km²), centred approximately 107 km northwest of Stonehenge, in the locality of Winton Shire Council.

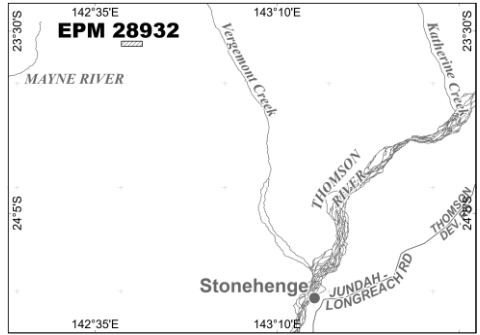

EPM 28933 applied for by AUSTRALIAN INDIGENOUS SECURITY SERVICE PTY LTD, ACN 122 200 622, over an area of 4 sub-blocks (12km²), centred approximately 87 km northwest of Stonehenge, in the locality of Barcoo Shire Council.

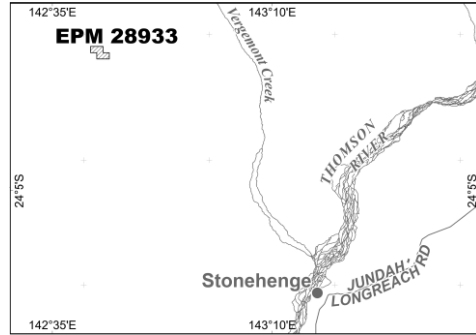

EPM 28935 applied for by Leonard Jessie Morris, over an area of 4 sub-blocks (12km²), centred approximately 123 km northwest of Stonehenge, in the locality of Winton Shire Council.

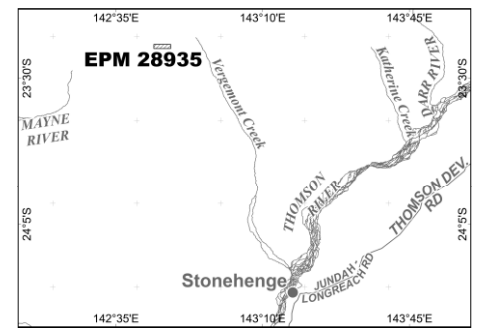

EPM 28961 applied for by Leonard Jessie Morris, over an area of 4 sub-blocks (12km²), centred approximately 107 km northwest of Stonehenge, in the locality of Winton Shire Council.

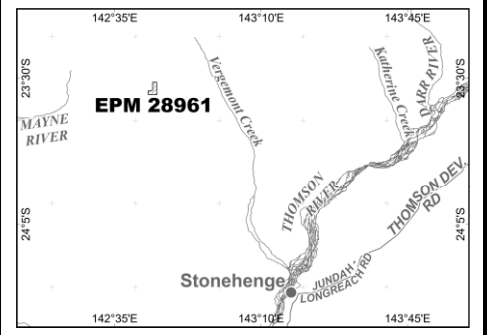

EPM 28962 applied for by Sharlene Pamela Pelentsov, over an area of 4 sub-blocks (12km²), centred approximately 132 km northwest of Stonehenge, in the locality of Winton Shire Council.

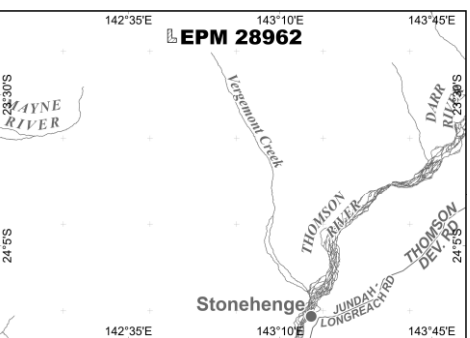

EPM 28963 applied for by Sharlene Pamela Pelentsov, over an area of 4 sub-blocks (12km²), centred approximately 133 km northwest of Stonehenge, in the locality of Winton Shire Council.

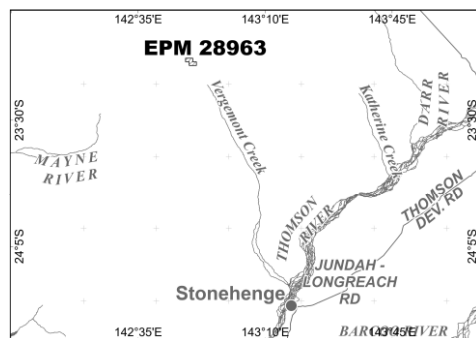

EPM 28969 applied for by ELLIS OPAL MINING PTY LIMITED, ACN 090 777 781, over an area of 4 sub-blocks (12km²), centred approximately 99 km northwest of Stonehenge, in the locality of Winton Shire Council.

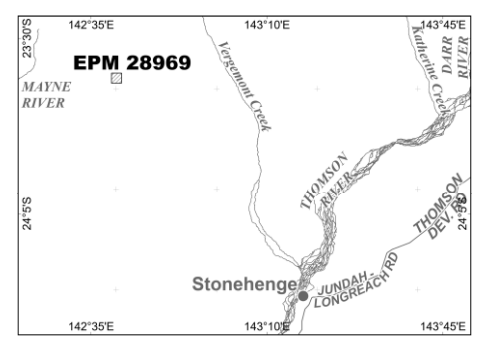

EPM 28970 applied for by ELLIS OPAL MINING PTY LIMITED, ACN 090 777 781, over an area of 4 sub-blocks (12km²), centred approximately 102 km northwest of Stonehenge, in the locality of Winton Shire Council.

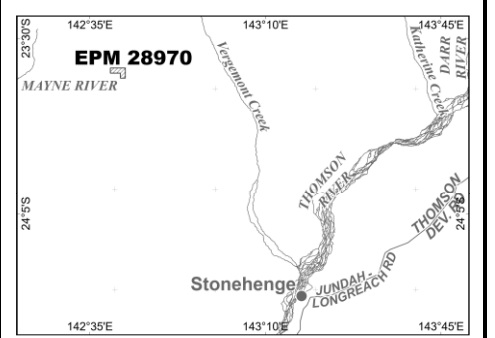

EPM 28971 applied for by D J CARMICHAEL BUILDING CONTRACTOR PTY LTD, ACN 132 165 612, over an area of 4 sub-blocks (12km²), centred approximately 80 km southwest of Winton, in the locality of Winton Shire Council.

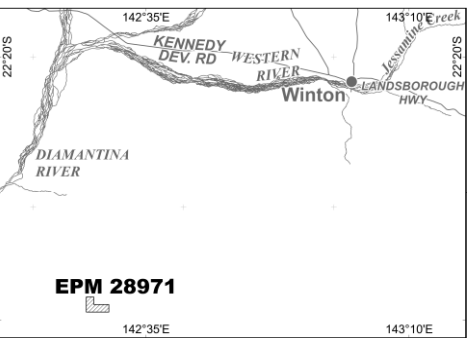

MC 300471 applied for by Rodney Gross, over an area of 18.75 hectares, centred approximately 162 km southwest of Winton, in the locality of Winton Shire Council.

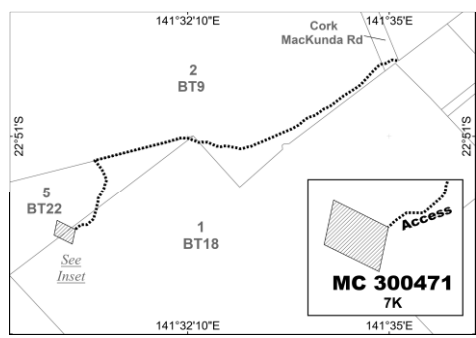

MC 300474 applied for by Dennis Ronald Byth, over an area of 12.47 hectares, centred approximately 148 km southwest of Winton, in the locality of Barcoo Shire Council.

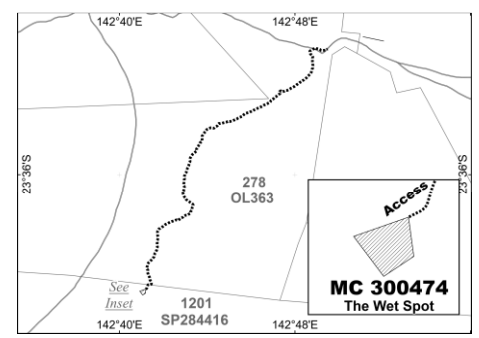

MC 300475 applied for by Neil Robert William Black, over an area of 19.66 hectares, centred approximately 120 km south southwest of Winton, in the locality of Winton Shire Council.

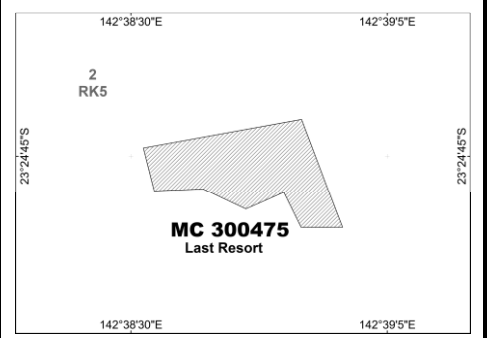

MC 300490 applied for by Laura Jane Argent, over an area of 0.9742 ha, centred approximately 1.15 km southwest of Yowah, in the locality of Paroo Shire Council.

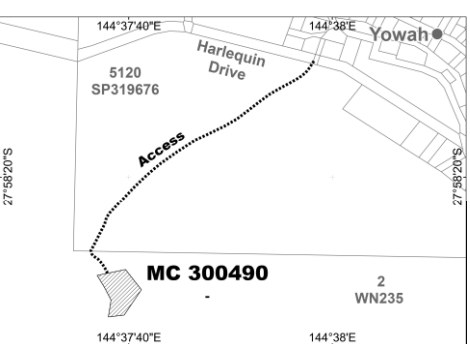

Nature of Act(s): The grant of the Exploration Permit for Minerals 28932, 28933, 28935, 28961, 28962, 28963, 28969 and 28970 under the *Mineral Resources Act 1989* (Qld), authorises the holder to explore for minerals subject to the provisions of the *Mineral Resources Act 1989* (Qld) for a term not exceeding two (2) years with the possibility of renewal for a term not exceeding two (2) years. The grant of the Exploration Permit for Minerals 28971 under the *Mineral Resources Act 1989* (Qld) authorises the holder to explore for minerals subject to the provisions of the *Mineral Resources Act 1989* (Qld) for a term not exceeding five (5) years with the possibility of renewal for a term not exceeding five (5) years. The grant of a Mining Claim under the *Mineral Resources Act 1989* (Qld) authorises the holder to mine and carry out associated activities subject to the *Mineral Resources Act 1989* (Qld), for a term not exceeding ten (10) years, with the possibility of renewals for a term not exceeding ten (10) years. The grant of the Mining Claim includes the granting of access as shown above.

Name and address of person doing Act(s): It is proposed that the Exploration Permit for Minerals and Mining Claim be granted subject to the provisions of the *Mineral Resources Act 1989* (Qld) by the Queensland Minister for Resources and Critical Minerals, PO Box 15216, City East, Queensland, 4002.

Native Title Parties: Under the *Native Title Act 1993* (Cth) any person who is a 'native title party' is entitled to certain rights in relation to the proposed grant of a Mining Claim. Under section 30 of the *Native Title Act 1993* (Cth), persons have until three (3) months after the Notification Day to take certain steps to become native title parties in relation to this notice. Enquiries in relation to filing a native title determination application may be directed to the Federal Court, Brisbane Registry, Level 6, Harry Gibbs Commonwealth Law Courts Building, 119 North Quay, Brisbane, Queensland 4000. Telephone: 1300 720 980 or Email: NativeTitleQLD@fedcourt.gov.au. Enquiries in relation to the registration of a native title determination application may be directed to the National Native Title Tribunal, Brisbane Registry, Level 5, Harry Gibbs Commonwealth Law Courts Building, 119 North Quay, Brisbane, Queensland 4000, Telephone: (07) 3052 4040.

Further Information: May be obtained from the Department of Resources, Mineral Assessment Hub, Level 9, Verde Tower, 445 Flinders Street, Townsville, Queensland, 4810. Telephone: (07) 4447 9230 or Email: MineralHub@resources.qld.gov.au or from the Small Scale Mining Hub, PO Box 275, Emerald, Queensland, 4720. Telephone: (07) 3078 3031 or Email: SSMHub@resources.qld.gov.au.

Notification Day: 5 June 2024

Dated 2 MAY 2024

Signed:

**Executive Director,
for Minister for Resources and Critical Minerals**

